

TQM/31, QM/32

Magnetically operated switch, Reed contact



- Alternative materials allows a wide range of application
- Switch with plug



Technical features

Operation: TQM/31, QM/32 normally open with LED (yellow)	Switching power: 50 W/50 VA max.	Protection rating (EN 60529): IP 66	Cable length: 2, 5 or 10 m
Switching voltage (U_b): 10 ... 240 V a.c./d.c.	Contact resistance: 100 mΩ	Shock resistance: 50 g (during 11 ms)	Electromagnetic compatibility according to: EN 60947-5-2
Switching voltage output: U _b - 2 V (QM/32)	Response time: 3 ms	Vibration resistance: 35 g (50 to 2000 Hz)	Materials: Body: plastic Cable: see table below
Switching current (see graph overleaf): 1 A max. (QM/32)	Operating temperature: -20 ... +80°C (-4 ... +176°F)	Cable type: PVC 2 x 0,75, PUR 2 x 0,75 VMQ 2 x 0,75 (TQM/31)	
	High temperature version: +150°C max. (TQM/31) (+302°F)		

Technical data

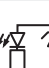
Symbol	Voltage (V a.c.) (V d.c.)	Current max. (A)	Function	Operating temperature (°C)	LED	Protection class	Features	Cable length (m)	Cable type	Weight (g)	Model
	10 ... 240	10 ... 240	1	Closer	-20 ... +80	•	IP66	—	2, 5 or 10	PVC 2 x 0,75	108 (2 m) QM/32/*
	10 ... 240	10 ... 240	1	Closer	-20 ... +80	•	IP66	—	2	PUR 2 x 0,75	108 QM/32/2/PU
	10 ... 240	10 ... 240	2	Closer	-20 ... +150	—	IP66	High temperature	2, 5 or 10	Silicon 2 x 0,75	102 (2 m) TQM/31/*
	10 ... 240	10 ... 240	1	Closer	-20 ... +80	•	IP66	Plug M12 x 1	—	—	15 QM/32/P *1)

* Insert cable length

*1) Plug-in connector see page 2

Color code: BK = black, BN = brown, BU = blue

Options selector

Options selector

★QM/3★/★/★

★

★

★

Variants	Substitute
High temperature (+150°C), for TQM/31/* only	T
Type	Substitute
Reed with LED	2
Reed without LED, for TQM/31/* only	1

Cable	Substitute
PVC	Without
PUR	PU
Cable length/plug	Substitute
2 m	2
5 m	5
10 m	10
With plug	Substitute
M12 x 1	P

Switching current and switching voltage

TQM/31

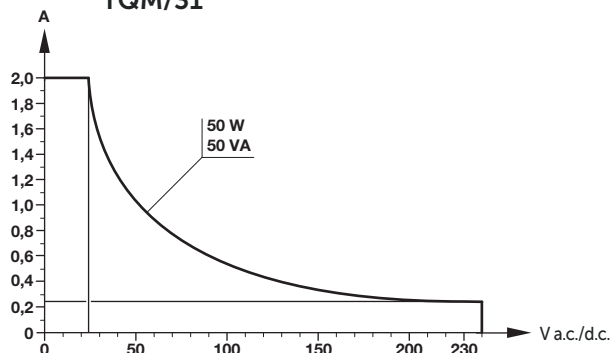

QM/32

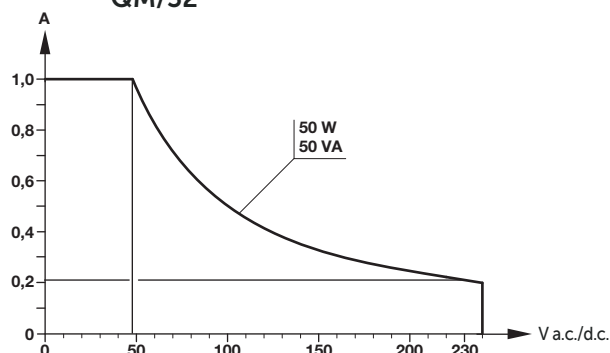

Mounting elements for magnetic switches

Cylinder with external tie rods
RA/8000/M, RA/28000/M



Cylinder with external tie rods
RM/900/M



Mounting elements

Mounting elements



Cylinder Ø (mm)	Model	Cylinder Ø (inch)	Model
32 ... 63	QM/31/032/22	1 1/4"	QM/31/032/22
80 ... 125	QM/31/080/22	1 3/4" + 2"	QM/31/080/22
160 + 200	QM/31/160/22	2 1/2" ... 4"	QM/31/2/22
250	QM/31/250/22		
320	QM/31/320/22		

Dimensions see relevant cylinder sheets.

Accessories

Plug-in connector cable with nut



Outer cover	Cable length	Weight (kg)	Connector	Model
PVC 3 x 0,34	5 m	0,182	M12 x 1	M/P34692/5
PUR 3 x 0,34	5 m	0,182	M12 x 1	M/P34594/5

Dimensions TQM/31, QM/32

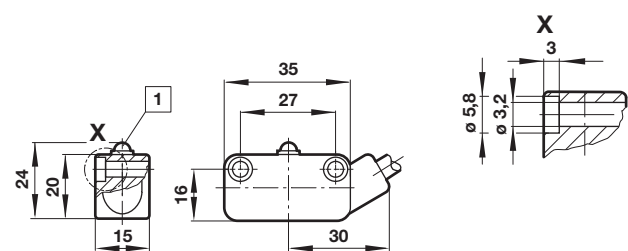

QM/32/P

Dimensions in mm
Projection/First angle

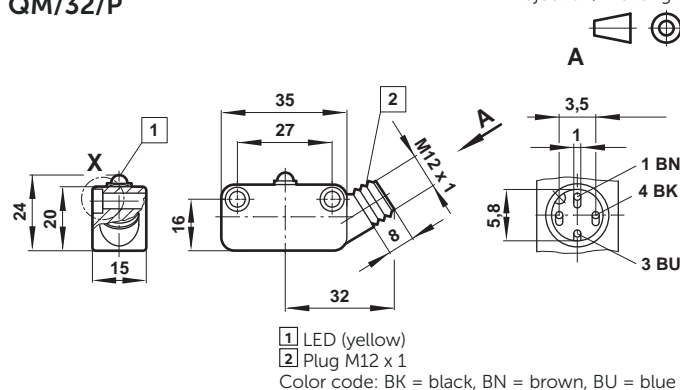

Warning

These products are intended for use in industrial compressed air systems only. Do not use these products where pressures and temperatures can exceed those listed under »Technical features/data«.

Before using these products with fluids other than those specified, for non-industrial applications, life-support systems or other applications not within published specifications, consult Norgren.

Through misuse, age, or malfunction, components used in fluid power systems can fail in various modes.

The system designer is warned to consider the failure modes of all component parts used in fluid power systems and to provide adequate safeguards to prevent personal injury or damage to equipment in the event of such failure.

System designers must provide a warning to end users in the system instructional manual if protection against a failure mode cannot be adequately provided.

System designers and end users are cautioned to review specific warnings found in instruction sheets packed and shipped with these products.